

Compact 3/2 normally closed metal bodied valves with push-in air connections. Designed for the process duty cycle with high durability. Ideal for the process or packaging industry.



- High durability
- Very good repeat accuracy
- Design for process duty cycle
- Push-in connection
- Versatile and easily maintained
- Miniature size

 **For ATEX specific products contact Sales Office**

Operating information				
Working pressure; PXC-M	3 to 8 bar			
Working temperature	-15 °C to +60 °C			
	<b>PXC-M111</b>	<b>PXC-M121</b>	<b>PXC-M521</b>	<b>PXC-M601</b>
Flow (Qmax):	60 l/min	85 l/min	250 l/min	250 l/min
For more information see <a href="http://www.parker.com/euro_pneumatic">www.parker.com/euro_pneumatic</a>				

**Bore Ø1,5 mm, flow 60 NI/min**

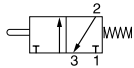
Symbol	Actuator	Return	Operating forces at 6 bar, N	Order code
	Steel plunger	Spring	11	<b>PXC-M111</b>

**Bore Ø1,5 mm, flow 85 NI/min**

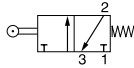
Symbol	Actuator	Return	Operating forces at 6 bar, N	Order code
	Plastic roller	Spring	4,5	<b>PXC-M121</b>
	Steel roller	Spring	4,5	<b>PXC-M131</b>

**Bore Ø2,5 mm, flow 250 NI/min**

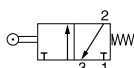
Symbol	Actuator	Return	Operating forces at 6 bar, N	Order code
	Plastic roller	Spring	7	<b>PXC-M521</b>

**3/2 compact limit switches - With Ø4mm Push-in connections with pipeable exhaust port**

**Bore Ø2,5mm, flow 250 NI/min - With plunger head**

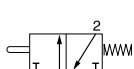
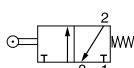
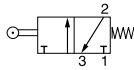
Symbol	Actuator	Return	Operating forces at 6 bar, N	Order code
	Steel plunger	Spring	24	<b>PXC-M601A110</b>
	Steel roller plunger	Spring	24	<b>PXC-M601A102</b>
	90° Steel roller plunger	Spring	24	<b>PXC-M601A103</b>

**Dimensions, Limit switches, Series PXC**

All dimensions in mm unless otherwise stated

**3/2 miniature limit switches**

**PXC-M111**

**PXC-Z12**

**PXC-Z11**

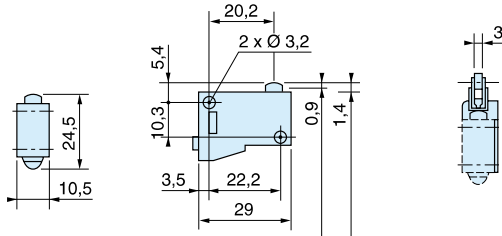

**PXC-M121 - PXC-M131**

**PXC-M521**

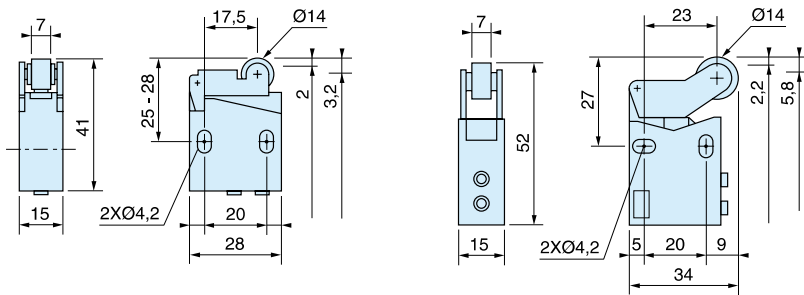

**3/2 compact limit switches**

**PXC-M601A102**

**PXC-M601A103**

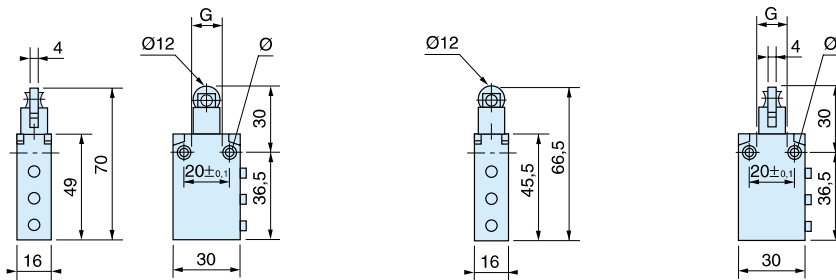

**PXC-M601A110**

